





# London Lane, Bromley, BR1

Guide Price £300,000

🛏️ 2 🍽️ 1 🚗 1

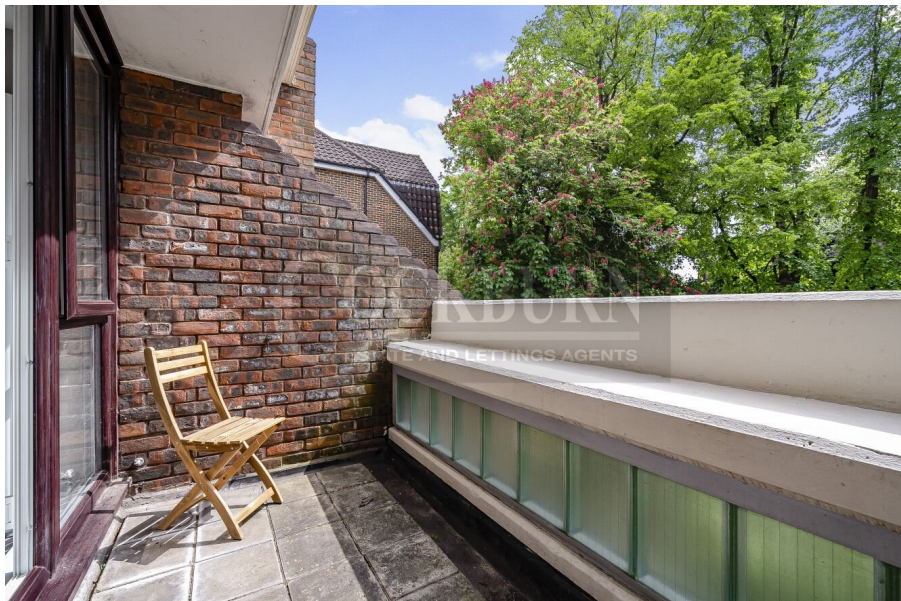

- Two Bedroom Flat
- Large Reception Room
- Balcony
- Ample Storage Space Throughout
- Lease Length 89 Years | Service Charge £870 Per Annum
- Perfect First Time Purchase Or Buy To Let Investment
- Easy Reach Of Shortlands & Bromley North Railway Stations
- Ideally Located For Bromley High Street Shops, Eateries & Amenities
- Excellent Bus Links Keeping You Connected With Bromley, Chislehurst & Surrounding Areas
- Council Tax Band C - London Borough Of Bromley







\*\*\* GUIDE PRICE £300,000 - £325,000 \*\*\*

**Introducing Redlands Court - A Superb Two Bedroom Apartment In The Heart Of Bromley.**

*Briefly comprising large reception, kitchen, bathroom, and two bedrooms, this property is in turn-key condition and is ready for its next owner to put their own stamp on! With ample storage space throughout, the property is finished to a good standard and would be the ideal first time purchase or buy to let investment alike! The property has the added benefit of a balcony area, which catches the sun perfectly, and also has allocated parking to the rear of the building.*



Redlands Court, London Lane, Bromley, BR1  
Approximate Area = 663 sq ft / 61.5 sq m  
For identification only - Not to scale

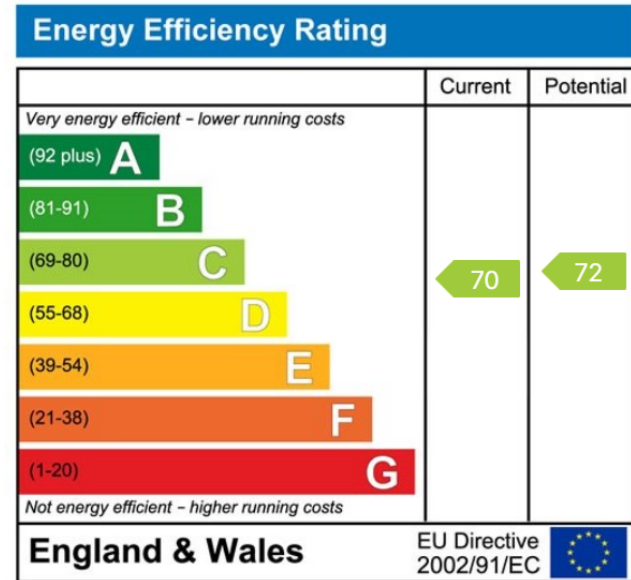
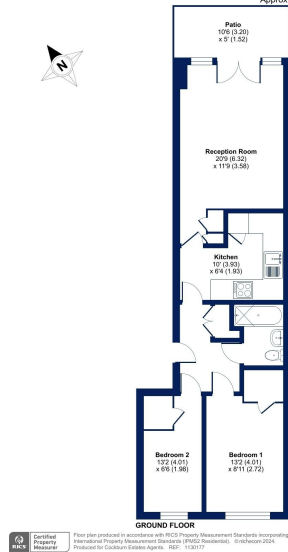

**Cockburn EA**

352 Footscray Road,  
London, SE9 2EB

t: 020 8859 8590